

- NOTES**
1. ALL DIMENSIONS IN METRES UNLESS SHOWN OTHERWISE.
 2. ALL LEVELS ARE IN METRES AND RELATE TO ORDNANCE DATUM UNLESS STATED OTHERWISE.
 3. DO NOT SCALE FROM THIS DRAWING. DO NOT TAKE DIGITAL DIMENSIONS OFF THIS DRAWING. WORK TO FIGURED DIMENSIONS ONLY - IF IN DOUBT ASK.
 4. REFER TO LANDSCAPE PROPOSAL FOR DETAILS OF SURFACING TYPE OF PROPOSED PATHS.
 5. REFER TO HIGHWAYS PROPOSAL FOR DETAILS OF ACCESS TO PARKING AND T BAYS.
 6. REFER TO BUILDING PROPOSAL FOR DETAILS OF BUILDING LAYOUT AND CAR PARKING PROPOSAL.

- LEGEND**
- HIGH POINT
 - LOW POINT
 - PROPOSED SWALE
 - PROPOSED SWALE WITH BUNDS
 - EXISTING DITCH RETAINED
 - PROPOSED CHAMBER
 - PROPOSED HEADWALL
 - PROPOSED CARRIER DRAIN
 - PROPOSED DETENTION BASIN
 - PROPOSED DETENTION BASIN (FORESTRY ENGLAND)
 - EXISTING BASIN
 - APPLICATION BOUNDARY

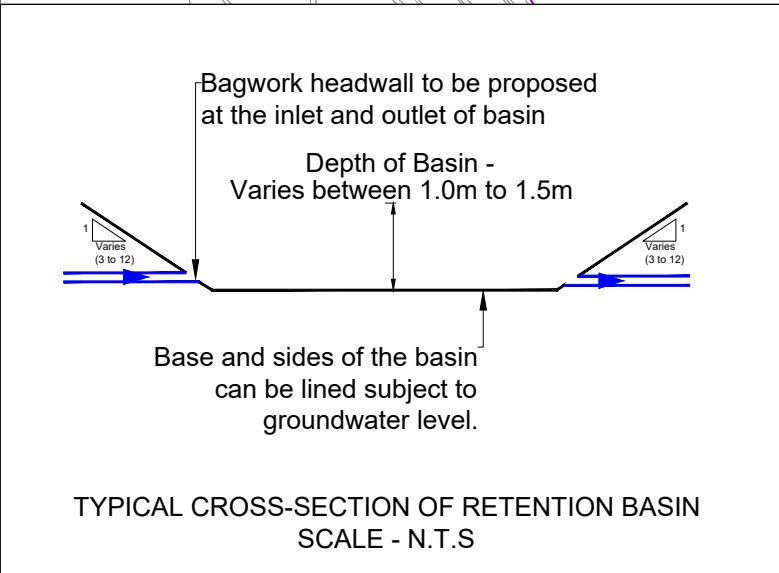
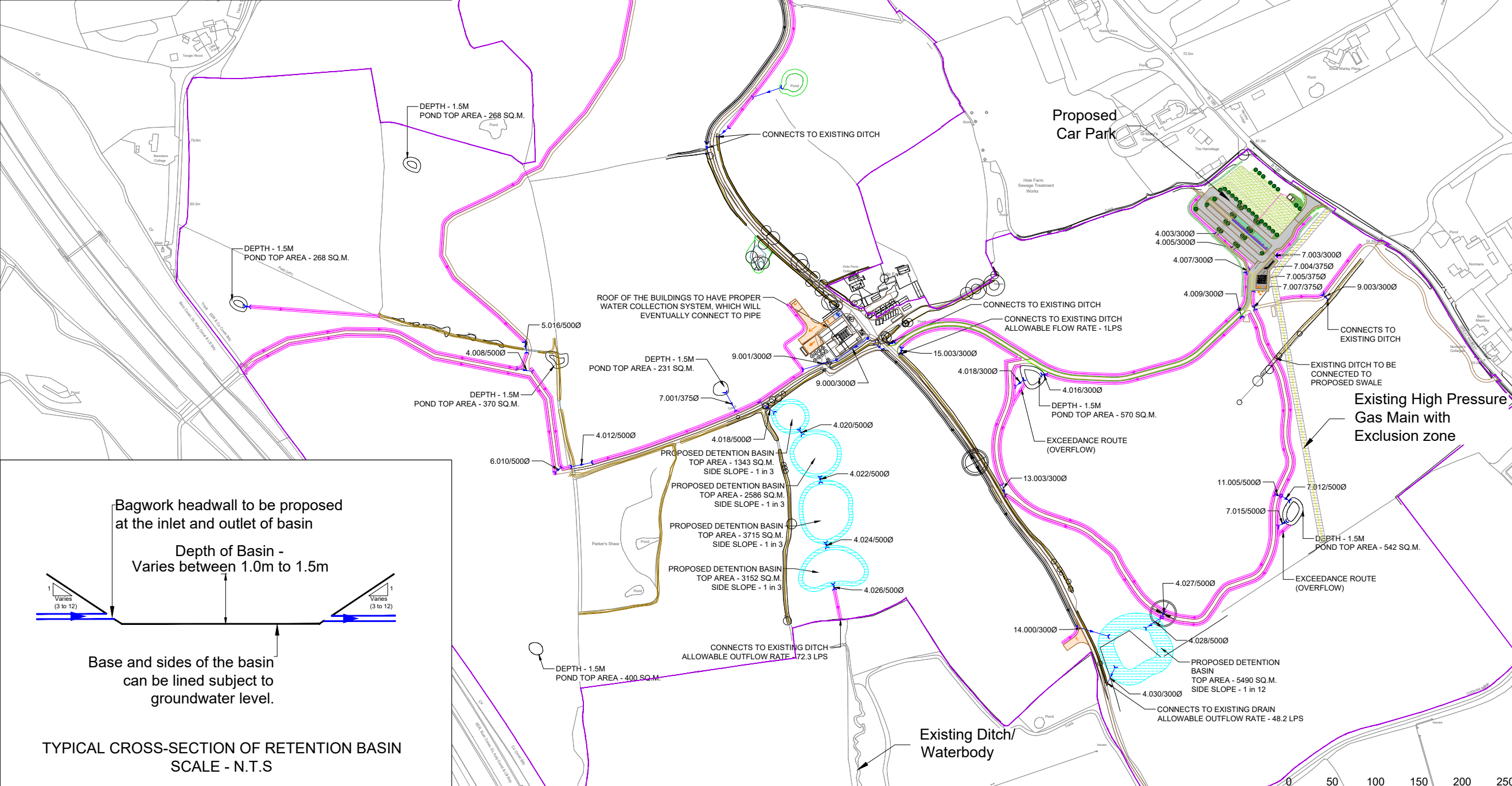

CURRENT VERSION INFORMATION
B. LIST CHANGES FOR CURRENT VERSION.

Rev	Revision Description	Drawn	Des'd	CHK'd	App'd	Date
R1	FOR APPROVAL	AS	AS	RC		14/04/23

THIS DRAWING IS THE PROPERTY OF COWI UK LIMITED AND MUST NOT BE COPIED OR USED FOR ANY PURPOSE OTHER THAN THAT FOR WHICH IT IS SUPPLIED. © COWI UK LTD

COWI Bevis Marks House, 24 Bevis Marks, London, EC3A 7JB, UK
Tel: +44 207 940 7800 E-Mail: info_@cowi.com

Client: **FORESTRY ENGLAND**

Project: **HOLE FARM COMMUNITY WOODLAND**

Title: **HOLE FARM PROPOSED DRAINAGE PLAN**

Drawn by: AS Designed by: AS Checked: RC

Date: 14/04/23 Orig. Sheet Size: A3 Approved:

Scales: 1:5000 Status: S2 - FIT FOR INFORMATION

Drawing No: HE540039-CJV-HDG-ZZZ_DN000000_Z-DR-CD-00001 Revision: A

Copyright: Contains Environment Agency information. © Environment Agency and/or database right.
Contains Ordnance Survey data. © Crown copyright and database rights 2020. Ordnance Survey 100030649

PLAN
1:5000

SCALE 1:5000 (A3)
SCALE 1:2500 (A1)
METRES